

# ATTENZIONE - ATTENTION - ACHTUNG

- Per lo smontaggio degli utensili utilizzare sempre la chiave di contrasto come indicato nel manuale d'uso.
- For disassembly of the tools use always the contrast key as mentioned in the user instructions.
- Fuer das Abmontieren der Werkzeuge immer den Gegenschlüssel benutzen wie in der Bedienungsanleitung erwaeht.

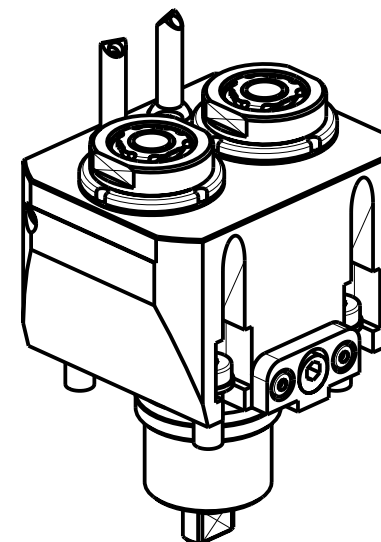

• Chiave inclusa

• Key included

• Schlüssel inbegriffen

| Cod. MT    | Mandrino<br>Spindle<br>Spindel | I   | RPM  | Coppia Max<br>Max Torque<br>Max Drehmoment | Lubrificazione est.<br>Ext. coolant<br>Aussenkuehlung | CHIAVI NON INCLUSE<br>Keys not included<br>Schlüssel nicht einbegriffen |            |        |
|------------|--------------------------------|-----|------|--|---|---|------------|--------|
| BGL1050216 | ERA16                          | 1:1 | 6000 | 20Nm                                       | X   | CHUB19_SP3  | CHTAER16ZC | CHUB30 |

BIGLIA

MOD: B436/438 - BMX 45Y2

MODULO MOTORIZZATO RADIALE 2 USCITE IN Y

Radial single side twin head driven tool in Y

Radial angetriebenes Werkzeug 2 Ausgaenge in Y

Subject to change without notice.

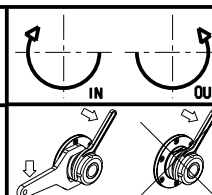

**M.T. srl**

Via Casino Albini 480

Tel. 0541/956034-957884

Fax 0541/956341

47842 S. GIOVANNI IN M. (RN)

e-mail: mtma@mtmarchetti.com

http://www.mtmarchetti.com



BGL080-2-00

09/2024